

## QP Series

SEALING  
SYSTEMS

QP1 and QP2 pump series are 100% dimensionally and hydraulically interchangeable with other brands in the market. Unlike the competition, Q-Pumps supplies the pump with a 304 stainless steel gearbox, without this great advantage implying an increase in the final price of the equipment.

### Characteristics

- Gearbox made of stainless steel, which makes it more resistant than conventional cast-iron gearboxes.
- 304 stainless steel seals.
- Helical gears
- Flexibility for 4 mounting positions.
- Solid 17-4 ph stainless steel shafts.
- Grease fittings on both sides.
- Antimicrobial lubricant.
- Alloy 88 rotors
- 6 threaded oil plugs with glass peepholes.
- Self-cleaning packages in the plugs.

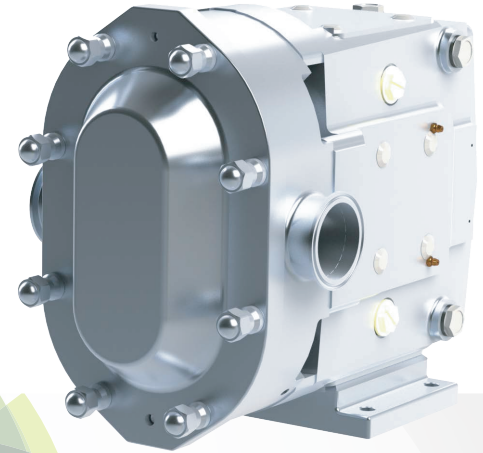

$\Phi$  312 GPM / 1,173 LPM

$\mu$  hasta 1,000,000 cP

P 500 psi / 34.5 bar  
1155 ft / 352 m

T 150 °C / 302 °F

### ADVANTAGES

Q-Pumps circumferential piston pumps are designed to cover all hygienic pumping applications in the food, dairy, beverage, pharmaceutical and other industries. Due to its reduced internal tolerances it has a wide range of applications, from low viscosity products such as water, to highly viscous products such as toothpaste.

- The oil-seal is made of stainless steel which prevents oxidation.
- High-torque shafts made of one alloy makes them more resistant.
- Self-cleaning gaskets.
- 100% interchangeable and compatible with other series in the market
- Remanufacturing program\*: Reconditioned pumps with a one-year warranty.

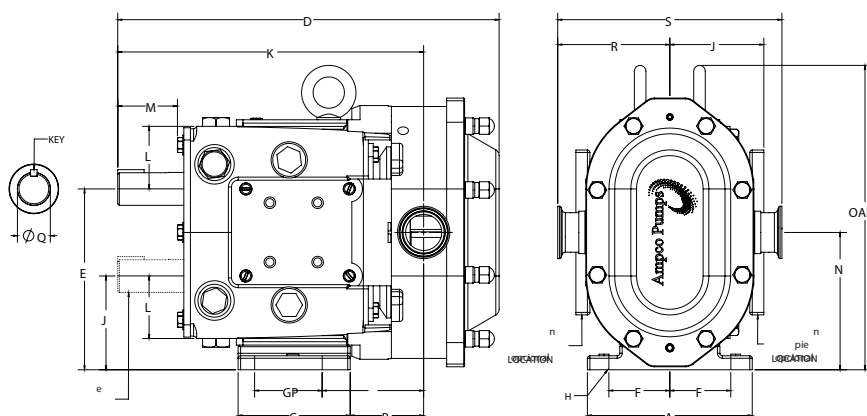

# SEALING SYSTEMS

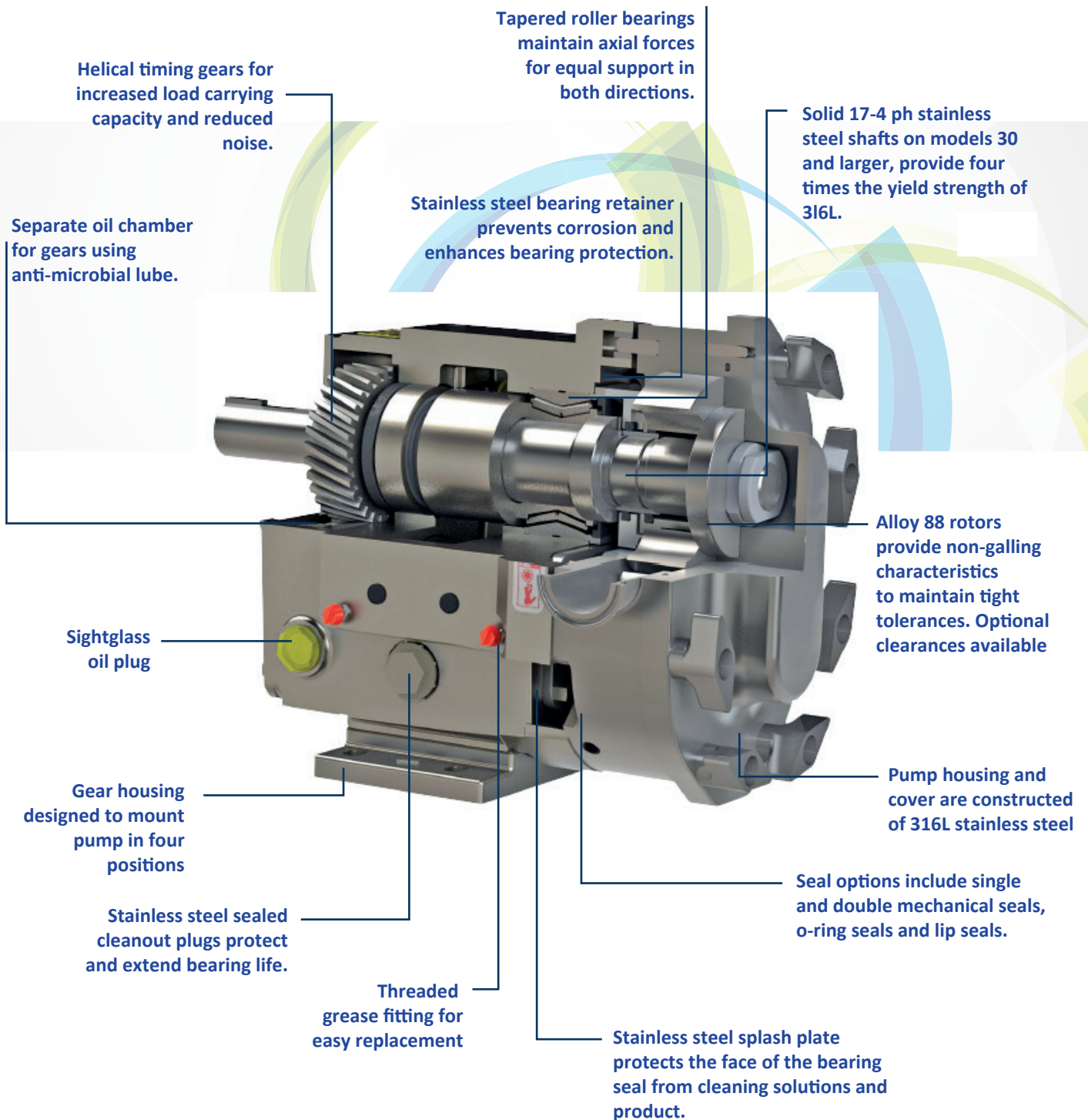

Helical timing gears for increased load carrying capacity and reduced noise.

Separate oil chamber for gears using anti-microbial lube.

Tapered roller bearings maintain axial forces for equal support in both directions.

Stainless steel bearing retainer prevents corrosion and enhances bearing protection.

Solid 17-4 ph stainless steel shafts on models 30 and larger, provide four times the yield strength of 316L.

Alloy 88 rotors provide non-galling characteristics to maintain tight tolerances. Optional clearances available

Sightglass oil plug

Gear housing designed to mount pump in four positions

Stainless steel sealed cleanout plugs protect and extend bearing life.

Threaded grease fitting for easy replacement

Seal options include single and double mechanical seals, o-ring seals and lip seals.

Pump housing and cover are constructed of 316L stainless steel

Stainless steel splash plate protects the face of the bearing seal from cleaning solutions and product.

## QP 1 + SERIES

The new QP1 + Series represents the improvements made to our well-known QP line, facilitating maintenance processes, saving time and costs.

- Design with O-Rings located on the front of the pump.
- The O-Rings can be changed without the need to disconnect the pump from the system.
- The design of a sleeve in one piece seals the pump when the rotors are removed for cleaning in place.
- Fewer parts, simpler maintenance, and shorter downtime give greater savings.
- 3-A certified

## QP 2 SERIES

QP2 Series with its stainless steel gearcase are built for CIP-ability with enclosed rotor nuts, can handle higher pressures with its larger 17-4ph stainless steel shafts and are capable of withstanding pressures of up to 500 PSI.

- Larger shafts to increase pump life.
- All QP2 pumps and equivalents can be converted into QP3.
- Cost and time savings due to its CIP capacity.
- Designed for Clean In Place.
- 3-A certified

## QP 3 SERIES

NEW!

The brand new QP3 series pumps with new rotor case design for maximum efficiency and a patented front-loading seal for ease-of-maintenance, eliminate all dead zones in the pump. 3-A & EHEDGH Certified.

- Front Loading Seal Design
- 304 Stainless Steel Gearcase
- Gasketed Stainless Steel Cleanout Plugs
- Alloy 88 Rotors
- Hardened Seal Faces Generate Less Heat
- Stainless Steel Bearing Retainers
- Helical Gears
- 4-Way Mounting
- Multiple Access Threaded Grease Zerks
- Anti-Microbial Lube
- Stainless Steel Splash Plate



### RENOVATION PROGRAM

The Remanufacturing Program provides a remanufactured pump with completely new shafts, bearings, seals, helical style gears and Alloy 88 rotors, allowing customers to purchase a new pump with a significant saving.



### PREMIUM ECONOMY

The Premium Economy or PE program is designed for customers who need immediate delivery or who demand lower costs for a premium quality pump. This program allows you to enjoy the benefits of the QP Series pumps, at an excellent price.